

Enquiry Question: What is an email?

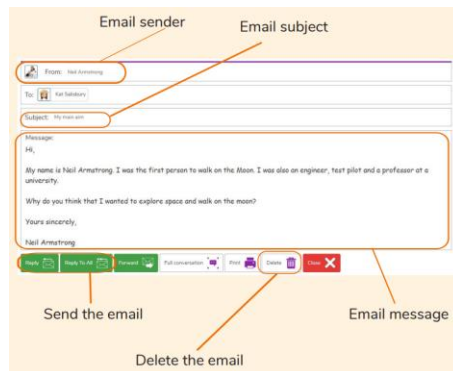

What should I already know?	What will I know at the end of the unit?
<ul style="list-style-type: none"> To log in safely. To learn how to find saved work in the Online Work area and find teacher comments. To learn how to search Purple Mash to find resources. To become familiar with the icons and types of resources available in the Topics section. To start to add pictures and text to work. To explore the Tools and Games section of Purple Mash. To learn how to open, save and print. To understand the importance of logging out. 	<ul style="list-style-type: none"> To know how to refine searches using the Search tool. To use digital technology to share work on Purple Mash to communicate and connect with others locally. To have some knowledge and understanding about sharing more globally on the Internet. To introduce Email as a communication tool using 2Respond simulations. To understand how we should talk to others in an online situation. To open and send simple online communications in the form of email. To understand that information put online leaves a digital footprint or trail. To identify the steps that can be taken to keep personal data and hardware secure.

Key Vocabulary		
Attachment Digital Footprint Email Filter	Internet Personal Information Private Information	Search Secure Sharing

Key Resources		
